



Série - TA

Especificações

Especificaciones

Features

Capacidade Capacidad Capacity	t	100 F1	100 F5	120 F1 2B	120 F5 2B	160 F1 2B	160 F5 2B	160 F6 2B	200 F5 2B	200 F6 2B	300 F5 2B	400 F5 2B	650 F1	1250 F5 2B
Curso do martelo Carrera del martillo Stroke length	mm	80	80	100	100	100	60	0 a 180	200	40 a 180	200	40	200	280
Velocidade Velocidad Speed	gpm	100	50	100 a 150	40 a 80	100 a 180	40 a 80	40 a 80	40 a 80	40	40 a 80	20 a 50	130	80
Mesa Mesa Bolster	mm	1000x650	1000x650	1200x850	1200x800	1500x1000	1500x1000	1500x1000	1800x1000	1800x1000	2200x1000	2200x1400	700x1000	900x1100
Altura de trabalho Altura de trabajo Working height	mm	2,5	2,5	2,5	5	2,5	5	5	5	5	5	1,5	6	-
Regulagem martelo Ajuste del martillo Slide adjustment	mm	100	100	100	100	150	150	150	150	150	200	200	12	12
Distância máx. mesa x martelo Distancia max. mesa y martillo Bolster to slide max. distance	mm	430	530	500	570	620	750	680	800	730	825	510	870	890
Altura ferramenta fechada Altura del troquel cerrado Die Height (S.D.A.U.)	mm	350	450	400	470	520	690	500	600	550	625	470	670	610
Espessura mesa sobreposta Espesor de la sobremesa Bolster plate thickness	mm	125	125	145	145	160	160	160	160	140	160	190	-	-
Altura piso à mesa Altura del piso a la mesa Floor to bolster height	mm	1000	1000	850	850	1050	1050	1050	1050	1050	1050	1000	900	900
Potência do motor Potencia del motor Main motor	cv	15	15	25	25	40	40	50	40	50	50	50	60	100
Peso aproximado Peso aproximado Approximate weight	kg	10460	8250	11500	11500	34000	34000	34000	43000	43000	40060	50500	38000	-

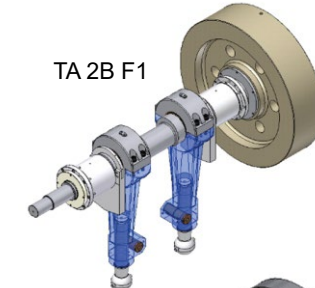

TA 2B F1

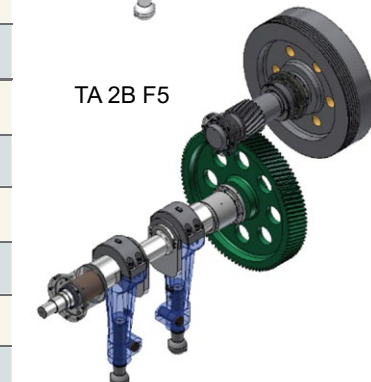

TA 2B F5

CINEMÁTICA CINEMÁTICA KINEMATICS

Dimensões

Dimensiones

Dimensions

Modelo Modelo Model	A	B	C	D	E	F	G	H	I	K	L	O	P
TA 100 F1 (mm)	1000	650	80	730	620	360	365	125	430	1000	2400	3770	1240
TA 100 F5 (mm)	1000	650	80	730	590	360	300	125	530	1000	2300	3650	1820
TA 120 F1 (mm)	1200	800	100	960	680	510	350	145	500	850	2720	3690	1200
TA 120 F5 (mm)	1200	800	100	960	630	500	380	145	570	850	3100	3850	2100
TA 160 F1 (mm)	1500	1000	100	1180	1000	600	600	160	620	1050	3150	4720	1530
TA 160 F5 (mm)	1500	1000	60	1400	960	650	600	160	750	1050	3910	4740	2710
TA 160 F6 (mm)	1500	1000	0/180	1310	980	600	600	160	680	1050	3210	4750	2330
TA 200 F5 (mm)	1800	1000	200	1610	980	600	600	160	800	1050	3500	5060	2200
TA 200 F6 (mm)	1800	1000	40/180	1760	980	600	600	140	730	1050	3900	5070	2200
TA 300 F5 (mm)	2200	1000	200	2050	980	620	600	160	825	1050	4350	5500	2300
TA 400 F5 (mm)	2200	1400	40	2160	1400	700	500	190	510	1000	4120	5240	3000
TA 650 F1 (mm)	700	940	200	620	750	870	320	-	870	900	2900	4800	1740
TA 1250 F5 (mm)	900	1100	280	850	850	120	890	-	890	900	-	-	-

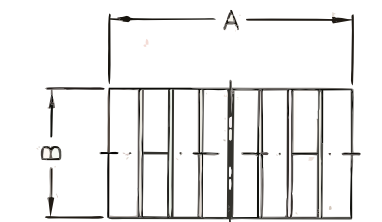
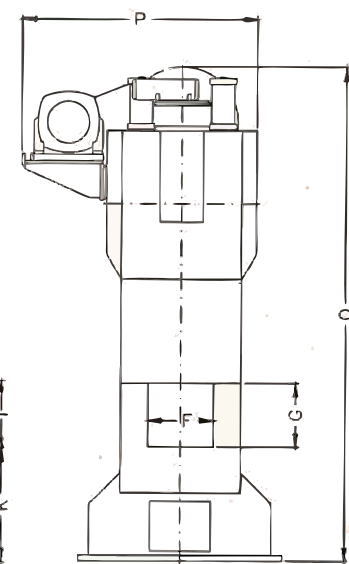
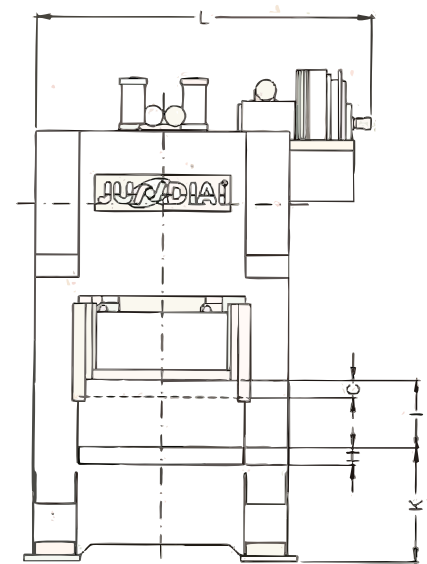

MESA
MESA
BOLSTER

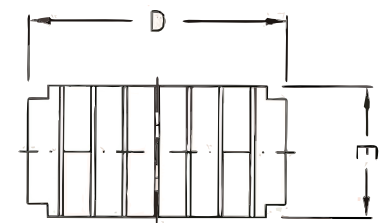

MARTELO
MARTILLO
SLIDE

Portugues Español English

F1 - Curso fixo / Volante F1 - Carrera fija / Volante F1 - Fixed Course / Steering wheel
 F5 - Curso Fijo / Engrenagem F5 - Carrera fija / Engranaje F5 - Fixed Course / Gear
 F6 - Engrenagem e mesa fixa F6 - Accionamiento engronado y mesa fija F6 - Gear and fixed bolster

www.prensajundiai.com.br vendas@prensajundiai.com.br

☎ 55 11 4039 8200 / 4039 8235

📍 Rod. Edgar Máximo Zamboto - Nº 5500 - Km 55 • Sítio Lagoa Branca • CEP 13231-700 • Campo Limpo Paulista • São Paulo • Brasil

Abril/2018